

CITY OF NAPOLEON WATER TAPPING PERMIT FORM

PERMIT #:

ISSUED:

JOB LOCATION: 1485 Williamsburg

SUBDIVISION NAME: Twin Oaks LOT #: _____

OWNER:

ADDRESS:

CONTRACTOR: _____ PHONE: _____

TAP SIZE: 1" X 1.5" _____ 2" _____ OTHER _____

AMOUNT PAID: _____ YOKE SIZE: _____

PLUMBING CONTRACTOR: _____ PH: _____

DATE OF TAP: 6-1-2000 OLD TAP #: _____ NEW TAP #: 0030

SIZE AND KIND OF MAIN: 8" C-900

LOCATION OF MAIN: 6' South of South curb DEPTH OF MAIN: 5'

DIST FROM HYDRANT VALVE: 142' W of Hyd 90 DIST TO CURB STOP FROM CORP: 15'

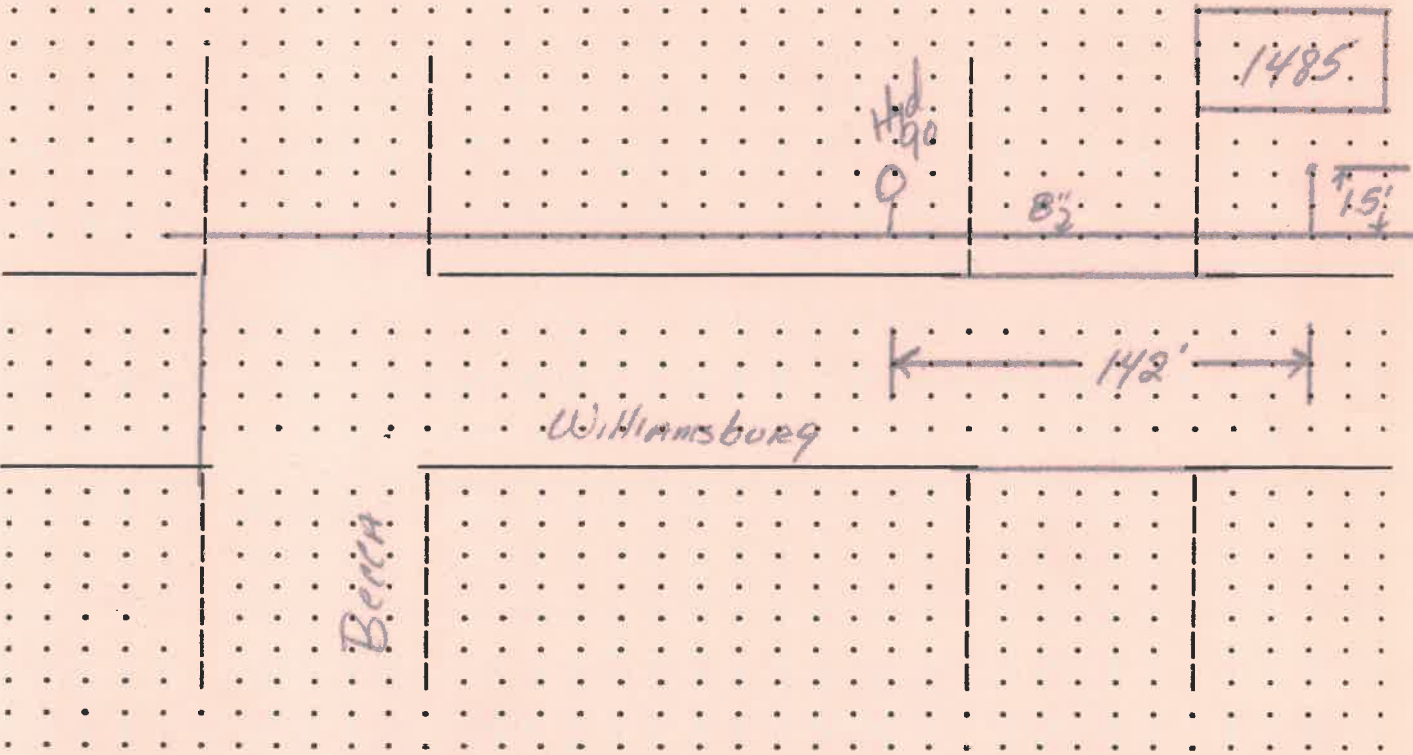

DATE APPROVED: Aug 28, 00

BY: Jeffrey E. Manting